

# Reflector REF-H33

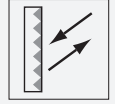

- M3 metal threaded insert

Reflector with screw fixing

## Dimensions

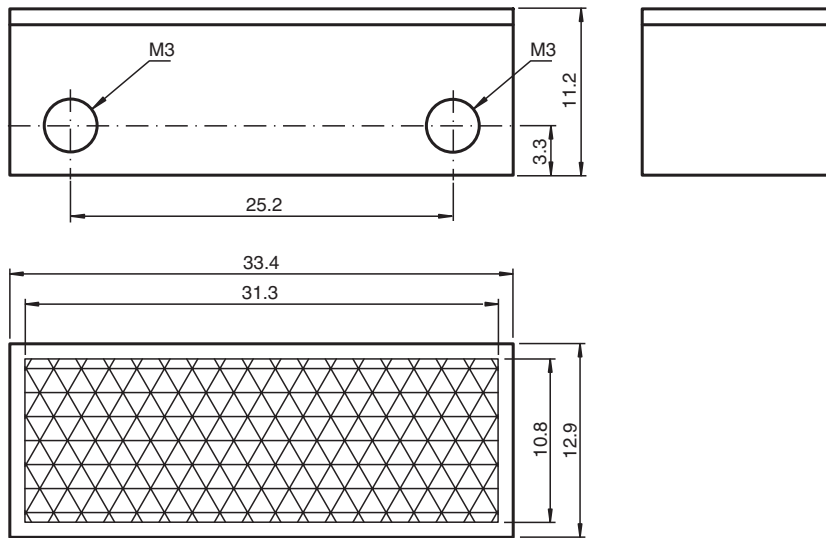

## Technical Data

### General specifications

Construction type rectangular

### Ambient conditions

Ambient temperature -30 ... 65 °C (-22 ... 149 °F)

### Mechanical specifications

Material PMMA/ABS

Dimensions 33.3 mm x 12.8 mm x 11 mm

Mounting M3 metal threaded insert

Release date: 2022-07-11 Date of issue: 2022-07-11 Filename: 232251\_eng.pdf

Refer to "General Notes Relating to Pepperl+Fuchs Product Information".

Pepperl+Fuchs Group  
www.pepperl-fuchs.com







USA: +1 330 486 0001  
fa-info@us.pepperl-fuchs.com

Germany: +49 621 776 1111  
fa-info@de.pepperl-fuchs.com

Singapore: +65 6779 9091  
fa-info@sg.pepperl-fuchs.com

**pf** PEPPERL+FUCHS

## Accessories

	<b>OMH-ML100-09</b>	Mounting aid for round steel $\varnothing$ 12 mm or sheet 1.5 mm ... 3 mm
	<b>OMH-10</b>	Mounting aid for ML100 series
	<b>OMH-ML100-01</b>	Mounting aid for ML100 series, mounting bracket
	<b>OMH-ML100-03</b>	Mounting aid for round steel $\varnothing$ 12 mm or sheet 1.5 mm ... 3 mm
	<b>OMH-ML100-04</b>	Mounting aid for ML100 series, mounting bracket
	<b>OMH-ML100-05</b>	Mounting aid for ML100 series, mounting bracket